

Si PIN photodiodes

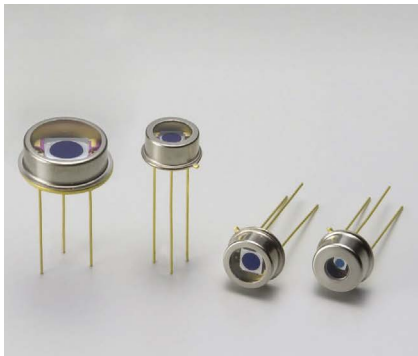

S3071

S3072

S3399

S3883

Large area, high-speed Si PIN photodiodes

The S3071, S3072, S3399 and S3883 are Si PIN photodiodes having a relatively large photosensitive area from $\phi 1.5$ to $\phi 5.0$ mm yet they offer excellent frequency response from 40 to 300 MHz. These photodiodes are suitable for FSO (free space optics) and high-speed pulsed light detection.

Features

- ➔ **Photosensitive area size**
S3071: $\phi 5.0$ mm
S3072: $\phi 3.0$ mm
S3399: $\phi 3.0$ mm
S3883: $\phi 1.5$ mm
- ➔ **Cutoff frequency**
S3071: 40 MHz ($V_R=24$ V)
S3072: 45 MHz ($V_R=24$ V)
S3399: 100 MHz ($V_R=10$ V)
S3883: 300 MHz ($V_R=20$ V)
- ➔ **High reliability: TO-5/8 metal package**

Applications

- ➔ **FSO**
- ➔ **High-speed pulsed light detection**

Structure / Absolute maximum ratings

Type no.	Dimensional outline/ Window material*1	Package	Photosensitive area size (mm)	Effective photosensitive area (mm ²)	Absolute maximum ratings			
					Reverse voltage V_R max. (V)	Power dissipation P_d (mW)	Operating temperature*2 T_{opr} (°C)	Storage temperature*2 T_{stg} (°C)
S3071	(1)/K	TO-8	$\phi 5.0$	19.6	50	50	-40 to +100	-55 to +125
S3072	(2)/K	TO-5	$\phi 3.0$	7.0				
S3399	(3)/K		$\phi 3.0$	7.0				
S3883	(4)/K		$\phi 1.5$	1.7	30			

*1: Window material K=borosilicate glass

*2: No condensation

When there is a temperature difference between a product and the surrounding area in high humidity environments, dew condensation may occur on the product surface. Dew condensation may cause deterioration in characteristics and reliability.

Note: Exceeding the absolute maximum ratings even momentarily may cause a drop in product quality. Always be sure to use the product within the absolute maximum ratings.

Electrical and optical characteristics (Typ. $T_a=25$ °C, unless otherwise noted)

Type no.	Spectral response range λ (nm)	Peak sensitivity wavelength λ_p (nm)	Photosensitivity S (A/W)			Short circuit current I_{sc} 100 lx (μ A)	Dark current I_D (nA)		Temp. coefficient of I_D T_{CID} (times/°C)	Cutoff frequency f_c $R_L=50 \Omega$ (MHz)	Terminal capacitance C_t $f=1$ MHz (pF)	Noise equivalent power NEP $\lambda=\lambda_p$ (W/Hz ^{1/2})	
			λ_p	660 nm	780 nm		830 nm	Typ.					Max.
S3071	320 to 1060	920	0.6	0.47	0.54	0.56	17	0.5*3	10*3	1.15	40*3	18*3	2.1 × 10 ⁻¹⁴ *3
S3072							6.5	0.3*3	10*3		45*3	7*3	1.6 × 10 ⁻¹⁴ *3
S3399	320 to 1000	840	0.6	0.45	0.58	0.6	5.6	0.1*4	1.0*4	1.12	100*4	20*4	9.4 × 10 ⁻¹⁵ *4
S3883							1.4	0.05*5	1.0*5		300*5	6*5	6.7 × 10 ⁻¹⁵ *5

*3: $V_R=24$ V *4: $V_R=10$ V *5: $V_R=20$ V

Spectral response

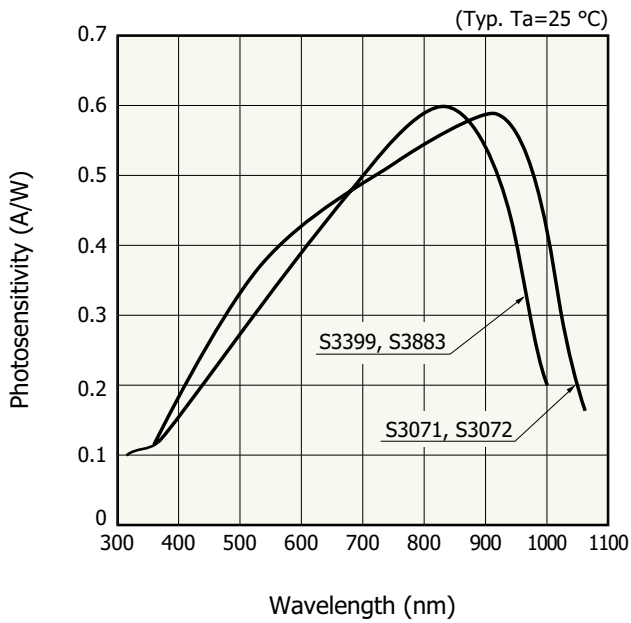

Photosensitivity temperature characteristics

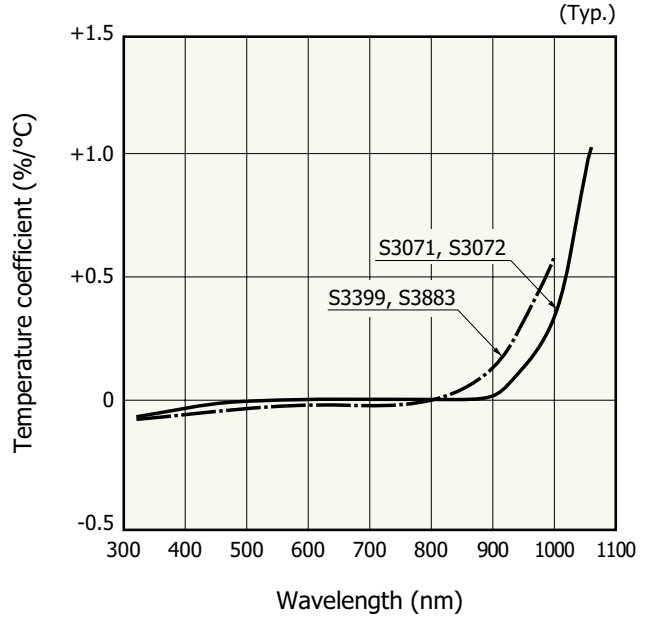

Dark current vs. reverse voltage

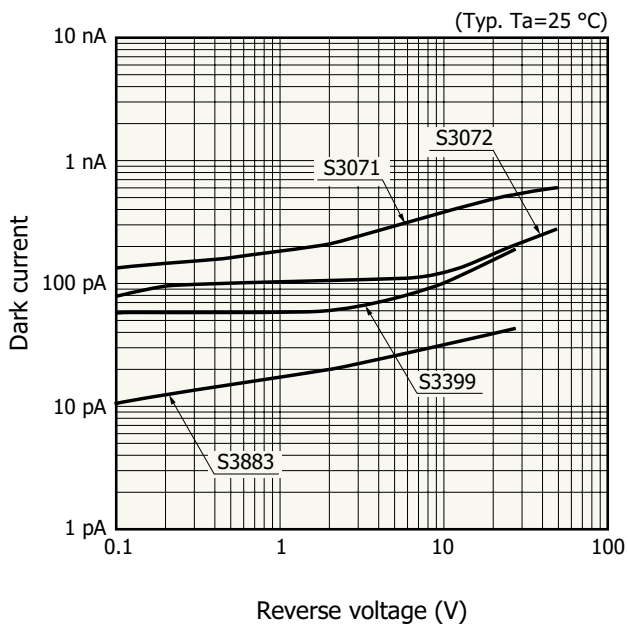

Terminal capacitance vs. reverse voltage

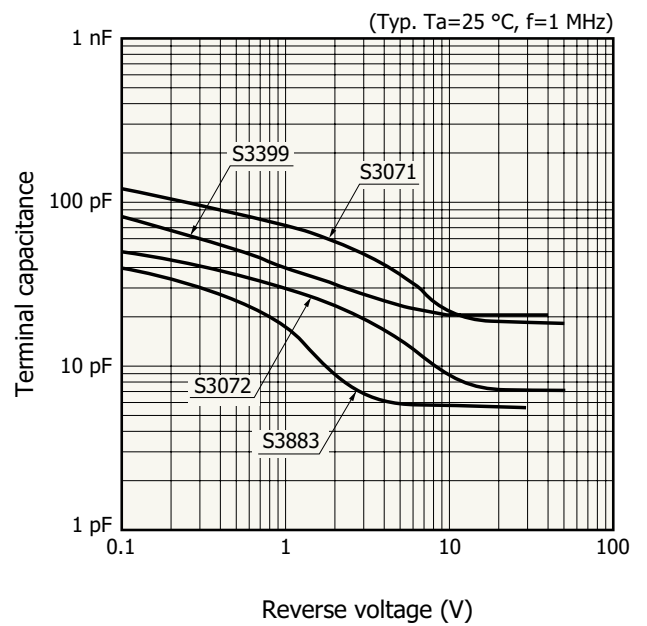

Dimensional outlines (unit: mm)

(1) S3071

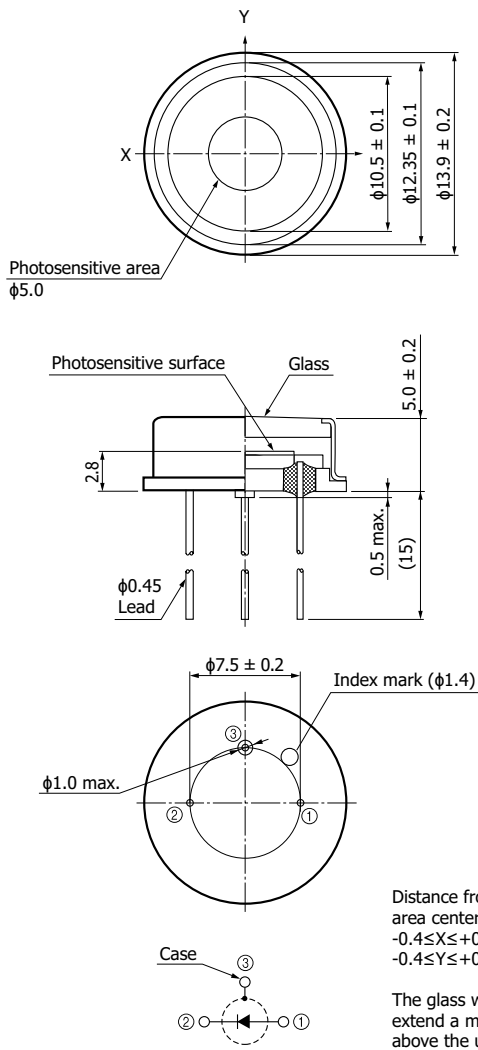

KPINA0027ED

(2) S3072

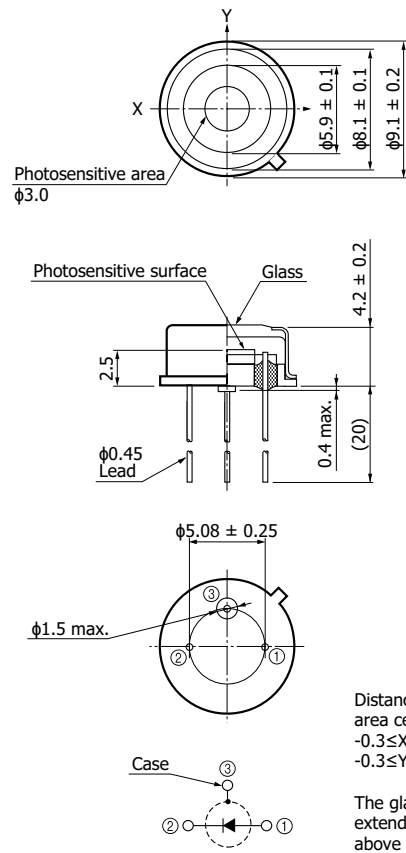

KPINA0024ED

(3) S3399

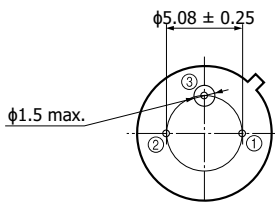
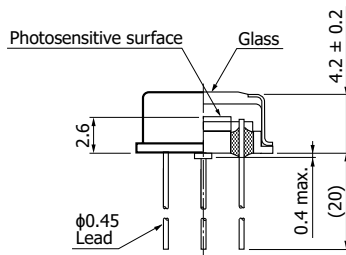
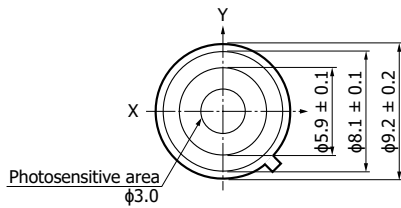

Distance from photosensitive area center to cap center
 $-0.3 \leq X \leq +0.3$
 $-0.3 \leq Y \leq +0.3$

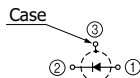

The glass window may extend a maximum of 0.15 mm above the upper surface of the cap.

KPINA0026ED

(4) S3883

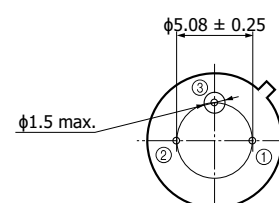
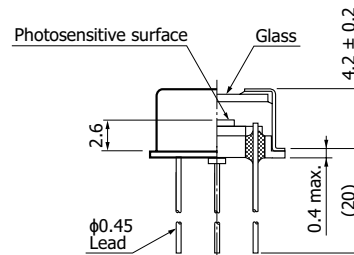
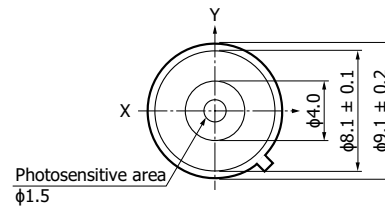

Distance from photosensitive area center to cap center
 $-0.3 \leq X \leq +0.3$
 $-0.3 \leq Y \leq +0.3$

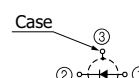

KPINA0025ED

Related information

www.hamamatsu.com/sp/ssd/doc_en.html

■ Precautions

- Disclaimer
- Metal, ceramic, plastic package products

■ Catalog

- Technical note / Si photodiodes

Information described in this material is current as of April, 2025.

Product specifications are subject to change without prior notice due to improvements or other reasons. This document has been carefully prepared and the information contained is believed to be accurate. In rare cases, however, there may be inaccuracies such as text errors. Before using these products, always contact us for the delivery specification sheet to check the latest specifications.

The product warranty is valid for one year after delivery and is limited to product repair or replacement for defects discovered and reported to us within that one year period. However, even if within the warranty period we accept absolutely no liability for any loss caused by natural disasters or improper product use. Copying or reprinting the contents described in this material in whole or in part is prohibited without our prior permission.

HAMAMATSU

www.hamamatsu.com

HAMAMATSU PHOTONICS K.K., Solid State Division

1126-1 Ichino-cho, Chuo-ku, Hamamatsu City, 435-8558 Japan, Telephone: (81)53-434-3311, Fax: (81)53-434-5184

U.S.A.: HAMAMATSU CORPORATION: 360 Foothill Road, Bridgewater, NJ 08807, U.S.A., Telephone: (1)908-231-0960, Fax: (1)908-231-1218

Germany: HAMAMATSU PHOTONICS DEUTSCHLAND GMBH: Arzbergerstr. 10, 82211 Herrsching am Ammersee, Germany, Telephone: (49)8152-375-0, Fax: (49)8152-265-8 E-mail: info@hamamatsu.de

France: HAMAMATSU PHOTONICS FRANCE S.A.R.L.: 19 Rue du Saule Trapu, Parc du Moulin de Massy, 91882 Massy Cedex, France, Telephone: (33)1 69 53 71 00, Fax: (33)1 69 53 71 10 E-mail: info@hamamatsu.fr

United Kingdom: HAMAMATSU PHOTONICS UK LIMITED: 2 Howard Court, 10 Tewin Road, Welwyn Garden City, Hertfordshire, AL7 1BW, UK, Telephone: (44)1707-294888, Fax: (44)1707-325777 E-mail: info@hamamatsu.co.uk

North Europe: HAMAMATSU PHOTONICS NORDEN AB: Torshamnsgatan 35, 16440 Kista, Sweden, Telephone: (46)8-509-031-00, Fax: (46)8-509-031-01 E-mail: info@hamamatsu.se

Italy: HAMAMATSU PHOTONICS ITALIA S.R.L.: Strada della Moia, 1 int. 6 20044 Arese (Milano), Italy, Telephone: (39)02-93 58 17 33, Fax: (39)02-93 58 17 41 E-mail: info@hamamatsu.it

China: HAMAMATSU PHOTONICS (CHINA) CO., LTD.: 1201, Tower B, Jiaming Center, 27 Dongsanhuan Bellu, Chaoyang District, 100020 Beijing, P.R. China, Telephone: (86)10-6586-6006, Fax: (86)10-6586-2866 E-mail: hpc@hamamatsu.com.cn

Taiwan: HAMAMATSU PHOTONICS TAIWAN CO., LTD.: 13F-1, No.101, Section 2, Gongdao 5th Road, East Dist., Hsinchu City, 300046, Taiwan(R.O.C) Telephone: (886)3-659-0080, Fax: (886)3-659-0081 E-mail: info@hamamatsu.com.tw