

### ■ Features

- Single emitter PLD
- Peak output power:  $\geq 20$  W
- Peak emission wavelength: 870 nm
- Emitting area size:  $230 \mu\text{m} \times 1 \mu\text{m}$

### ■ Applications

- Laser range finder
- Security
- Measuring instruments



### ■ Absolute maximum ratings ( $T_{\text{op}(c)} = 25 \text{ }^\circ\text{C}$ )

Parameter	Symbol	Value	Unit
Pulsed forward current	$I_{\text{fp}}$	25	A
Reverse voltage	$V_{\text{r}}$	2	V
Pulse duration	$t_{\text{w}}$	100	ns
Duty ratio	DR	0.1	%
Operating temperature	$T_{\text{op}(c)}$	-40 to +85	$^\circ\text{C}$
Storage temperature	$T_{\text{stg}}$	-40 to +100	$^\circ\text{C}$

### ■ Characteristics ( $T_{\text{op}(c)} = 25 \text{ }^\circ\text{C}$ )

Parameter	Symbol	Conditions	Value			Unit
			Min.	Typ.	Max.	
Pulsed radiant power (Peak power)	$\Phi_{\text{ep}}$	$I_{\text{fp}} = 20 \text{ A}$	19	22	—	W
Peak emission wavelength	$\lambda_{\text{p}}$		860	870	880	nm
Forward voltage	$V_{\text{f}}$		—	7	—	V
Spectral radiation half bandwidth	$\Delta\lambda$		—	4	—	nm
Rise time	$t_{\text{r}}$		—	—	2	ns
Beam spread angle	Horizontal	$I_{\text{fp}} = 20 \text{ A}$ FWHM	7	10	13	degree
	Vertical		$\theta_{\perp}$	25	30	35
Lasing threshold current	$I_{\text{th}}$	—	—	0.8	—	A
Emitting area size	—	Value at designing	—	$230 \times 1$	—	$\mu\text{m} \times \mu\text{m}$

Note: General operating condition: pulse width  $t_{\text{w}} = 50 \text{ ns}$ , repetition frequency  $f_{\text{r}} = 1 \text{ kHz}$

# Pulsed Laser Diode L11649-120-04

Figure 1: Radiant flux vs. Forward current (Typ.)

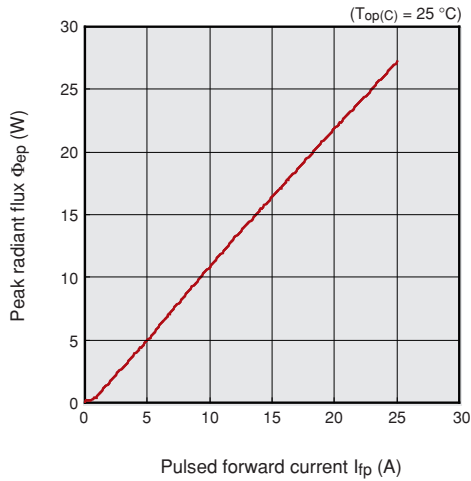

Figure 2: Emission spectrum (Typ.)

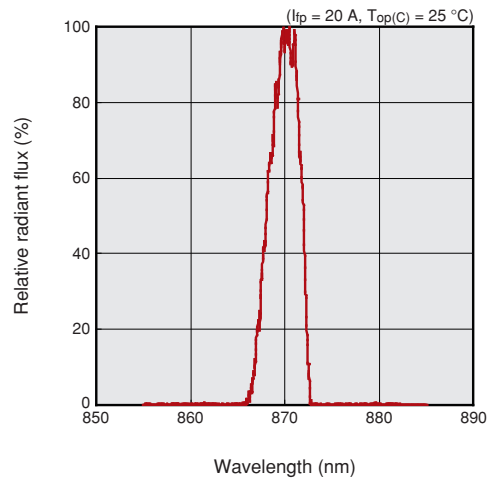

Figure 3: Directivity (Typ.)

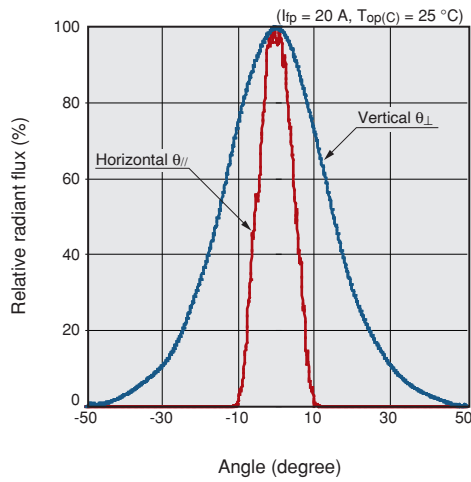
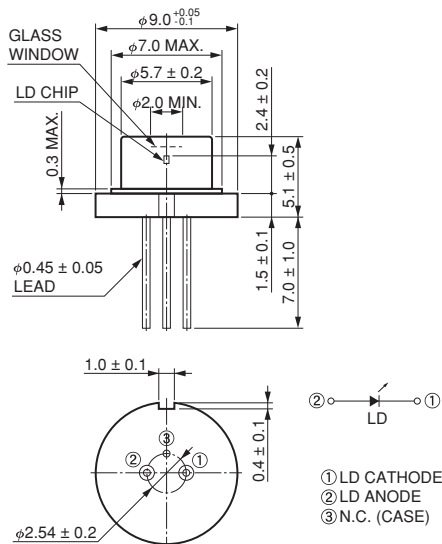
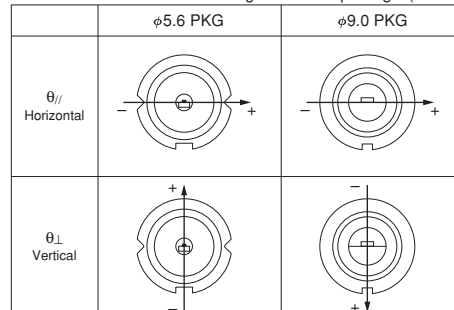

Figure 4: Dimensional outline (unit: mm)



Directions of far field patterns (FFP), horizontal and vertical direction against at can package. (Front of view)



Information described in this material current as of October 2023. Specifications are subject to change without notice.

## HAMAMATSU PHOTONICS K.K. [www.hamamatsu.com](http://www.hamamatsu.com)

**HAMAMATSU PHOTONICS K.K., Solid State Division**  
 1126-1 Ichino-cho, Higashi-ku, Hamamatsu City, 435-8558 Japan, Telephone: (81)53-434-3311, Fax: (81)53-434-5184

U.S.A.: HAMAMATSU CORPORATION: 360 Foothill Road, Bridgewater, NJ 08807, U.S.A., Telephone: (1)908-231-0960, Fax: (1)908-231-1218 E-mail: [usa@hamamatsu.com](mailto:usa@hamamatsu.com)  
 Germany: HAMAMATSU PHOTONICS DEUTSCHLAND GMBH.: Arzbergerstr. 10, 82211 Herrsching am Ammersee, Germany, Telephone: (49)8152-375-0, Fax: (49)8152-265-8 E-mail: [info@hamamatsu.de](mailto:info@hamamatsu.de)  
 France: HAMAMATSU PHOTONICS FRANCE S.A.R.L.: 19 Rue du Saule Trapu, Parc du Moulin de Massy, 91882 Massy Cedex, France, Telephone: (33)1 69 53 71 00, Fax: (33)1 69 53 71 10 E-mail: [infos@hamamatsu.fr](mailto:infos@hamamatsu.fr)  
 United Kingdom: HAMAMATSU PHOTONICS UK LIMITED: 2 Howard Court, 10 Tewin Road, Welwyn Garden City, Hertfordshire, AL7 1BW, UK, Telephone: (44)1707-294888, Fax: (44)1707-325777 E-mail: [info@hamamatsu.co.uk](mailto:info@hamamatsu.co.uk)  
 North Europe: HAMAMATSU PHOTONICS NORDEN AB: Torshamnsgatan 35, 16440 Kista, Sweden, Telephone: (46)8-509-031-00, Fax: (46)8-509-031-01 E-mail: [info@hamamatsu.se](mailto:info@hamamatsu.se)  
 Italy: HAMAMATSU PHOTONICS ITALIA S.R.L.: Strada della Moia, 1 int. 6 20044 Arese (Milano), Italy, Telephone: (39)02-93 58 17 33, Fax: (39)02-93 58 17 41 E-mail: [info@hamamatsu.it](mailto:info@hamamatsu.it)  
 China: HAMAMATSU PHOTONICS (CHINA) CO., LTD.: 1201, Tower B, Jianning Center, 27 Dongsanhuan Beilu, Chaoyang District, 100020 Beijing, P.R. China, Telephone: (86)10-6586-6006, Fax: (86)10-6586-2866 E-mail: [hpc@hamamatsu.com.cn](mailto:hpc@hamamatsu.com.cn)  
 Taiwan: HAMAMATSU PHOTONICS TAIWAN CO., LTD.: 13F-1, No.101, Section 2, Gongdao 5th Road, East Dist., Hsinchu City, 300046, Taiwan (R.O.C) Telephone: (886)3-659-0080, Fax: (886)3-659-0081 E-mail: [info@hamamatsu.com.tw](mailto:info@hamamatsu.com.tw)