



L14337-0085R

High-speed response LED for optical switches

The L14337-0085R is an infrared LED developed for optical switches. It is a high-speed response LED featuring a cutoff frequency of 50 MHz (typ.).

Features

- ➔ High light output
- ➔ High-speed response

Applications

- ➔ Optical switches

Structure

Parameter	Specification
Package	TO-46
Reflector	Yes
Window material	Epoxy resin

Absolute maximum ratings (Ta=25 °C unless otherwise noted)

Parameter	Symbol	Condition	Value	Unit
Reverse voltage	VR		5	V
Forward current	IF		80	mA
Forward current decrease rate	-	Ta > 25 °C	0.8	mA/°C
Pulse forward current	IFP	Pulse width=10 μs Duty ratio=1%	1.0	A
Pulse forward current decrease rate	-	Ta > 25 °C	10	mA/°C
Power dissipation	P		150	mW
Operating temperature	Topr	No dew condensation*1	-30 to +85	°C
Storage temperature	Tstg	No dew condensation*1	-40 to +100*2	°C

*1: When there is a temperature difference between a product and the surrounding area in high humidity environment, dew condensation may occur on the product surface. Dew condensation on the product may cause deterioration in characteristics and reliability.

*2: The L14337-0085R is guaranteed to resist temperature cycle test of up to 5 cycles.

Note: Exceeding the absolute maximum ratings even momentarily may cause a drop in product quality. Always be sure to use the product within the absolute maximum ratings.

Electrical and optical characteristics (Ta=25 °C)

Parameter	Symbol	Condition	Min.	Typ.	Max.	
Peak emission wavelength	λ_p	IF=50 mA	820	850	880	nm
Spectral half width	$\Delta\lambda$	IF=50 mA	-	45	-	nm
Forward voltage	VF	IF=50 mA	-	1.5	1.7	V
Reverse current	IR	VR=5 V	-	-	10	μA
Radiant flux	ϕ_e	IF=50 mA	9	13	-	mW
Cutoff frequency*3	fc	IF=50 mA ± 4 mAp-p	35	50	-	MHz

*3: Frequency at which the optical output drops by 3 dB relative to the output at 100 kHz

Emission spectrum

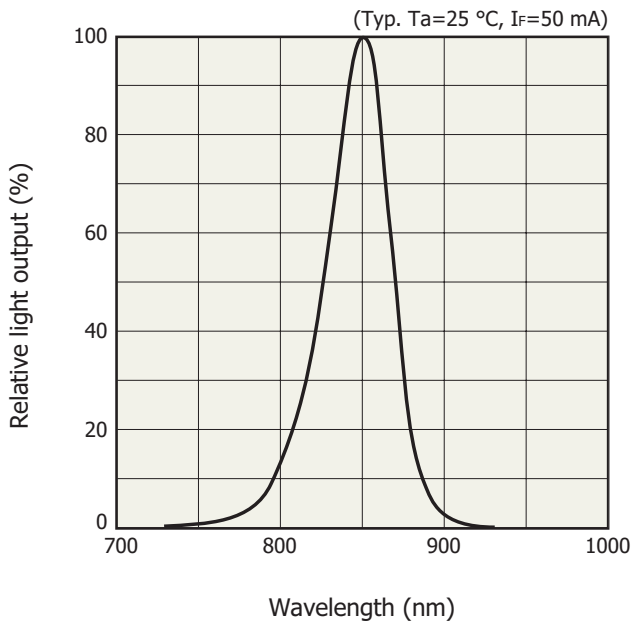

KLEDB0522EA

Radiant flux vs. pulse forward current

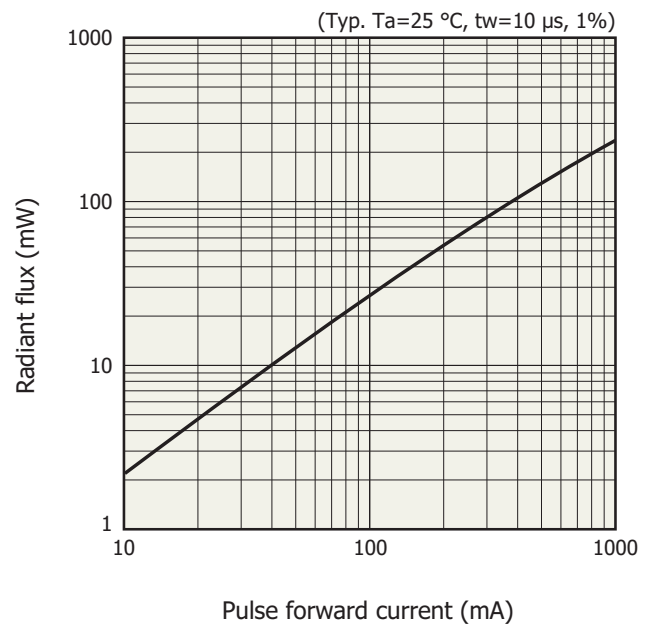

KLEDB0523EA

Pulse forward current vs. pulse forward voltage

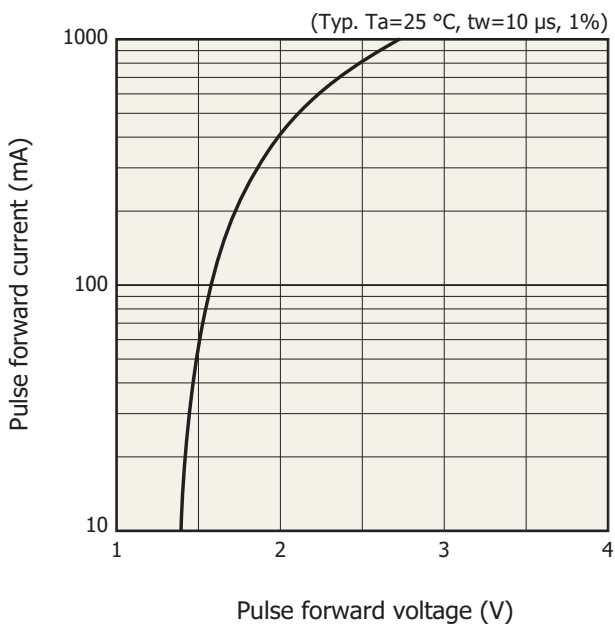

KLEDB0524EA

Directivity

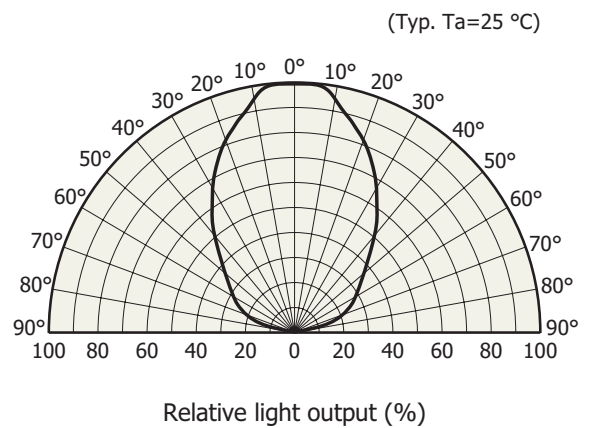

KLEDB0520EA

Light output vs. ambient temperature

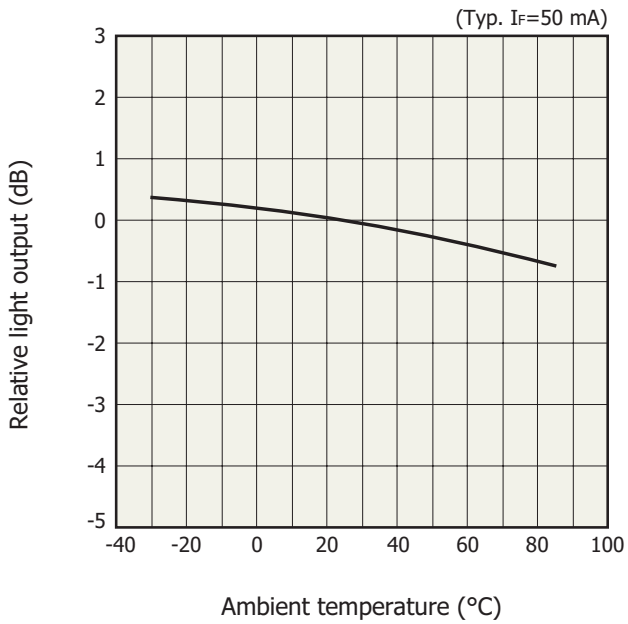

KLEDB0525EA

Allowable forward current vs. ambient temperature

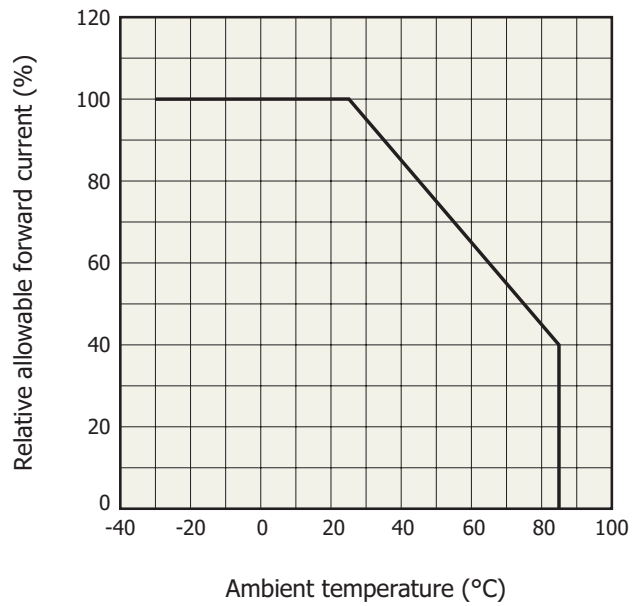

KLEDB0495EB

Allowable forward current vs. duty ratio

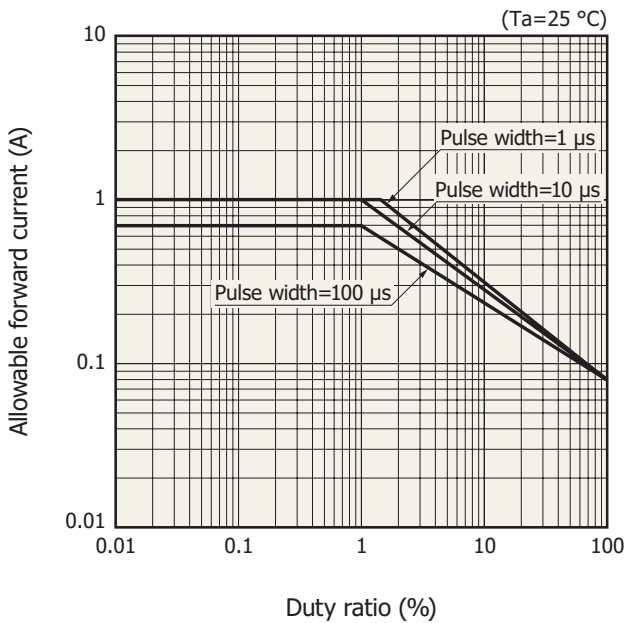

KLEDB0038EB

Dimensional outline (unit: mm)

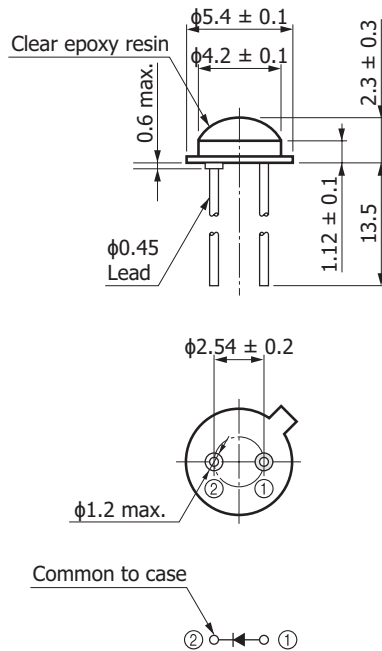

KLEDA0058EB

Standard packing specifications

- Packing state: Paper box (200 pieces/box)

Related information

http://www.hamamatsu.com/sp/ssd/doc_en.html

■ Precautions

- Disclaimer
- Safety consideration
- Compound opto-semiconductors (photosensors, light emitters)

■ Technical information

- LED / Technical note

Information described in this material is current as of May 2022.

Product specifications are subject to change without prior notice due to improvements or other reasons. This document has been carefully prepared and the information contained is believed to be accurate. In rare cases, however, there may be inaccuracies such as text errors. Before using these products, always contact us for the delivery specification sheet to check the latest specifications.

The product warranty is valid for one year after delivery and is limited to product repair or replacement for defects discovered and reported to us within that one year period. However, even if within the warranty period we accept absolutely no liability for any loss caused by natural disasters or improper product use. Copying or reprinting the contents described in this material in whole or in part is prohibited without our prior permission.

HAMAMATSU

www.hamamatsu.com

HAMAMATSU PHOTONICS K.K., Solid State Division

1126-1 Ichino-cho, Higashi-ku, Hamamatsu City, 435-8558 Japan, Telephone: (81)53-434-3311, Fax: (81)53-434-5184

U.S.A.: HAMAMATSU CORPORATION: 360 Foothill Road, Bridgewater, NJ 08807, U.S.A., Telephone: (1)908-231-0960, Fax: (1)908-231-1218 E-mail: usa@hamamatsu.com

Germany: HAMAMATSU PHOTONICS DEUTSCHLAND GMBH.: Arzbergerstr. 10, 82211 Herrsching am Ammersee, Germany, Telephone: (49)8152-375-0, Fax: (49)8152-265-8 E-mail: info@hamamatsu.de

France: HAMAMATSU PHOTONICS FRANCE S.A.R.L.: 19, Rue du Saule Trapu, Parc du Moulin de Massy, 91882 Massy Cedex, France, Telephone: (33)1 69 53 71 00, Fax: (33)1 69 53 71 10 E-mail: infos@hamamatsu.fr

United Kingdom: HAMAMATSU PHOTONICS UK LIMITED: 2 Howard Court, 10 Tewin Road, Welwyn Garden City, Hertfordshire AL7 1BW, UK, Telephone: (44)1707-294888, Fax: (44)1707-325777 E-mail: info@hamamatsu.co.uk

North Europe: HAMAMATSU PHOTONICS NORDEN AB: Torshamnsgatan 35 16440 Kista, Sweden, Telephone: (46)8-509 031 00, Fax: (46)8-509 031 01 E-mail: info@hamamatsu.se

Italy: HAMAMATSU PHOTONICS ITALIA S.R.L.: Strada della Moia, 1 int. 6, 20044 Arese (Milano), Italy, Telephone: (39)02-93 58 17 33, Fax: (39)02-93 58 17 41 E-mail: info@hamamatsu.it

China: HAMAMATSU PHOTONICS (CHINA) CO., LTD.: 1201 Tower B, Jianning Center, 27 Dongsanhuan Beilu, Chaoyang District, 100020 Beijing, P.R. China, Telephone: (86)10-6586-6006, Fax: (86)10-6586-2866 E-mail: hpc@hamamatsu.com.cn

Taiwan: HAMAMATSU PHOTONICS TAIWAN CO., LTD.: 8F-3, No.158, Section 2, Gongdao 5th Road, East District, Hsinchu, 300, Taiwan R.O.C. Telephone: (886)3-659-0080, Fax: (886)3-659-0081 E-mail: info@hamamatsu.com.tw